

LIMITED ONE YEAR WARRANTY

Chaney Instrument Company warrants that all products it manufactures to be of good material and workmanship and to be free of defects if properly installed and operated for a period of one year from date of purchase. REMEDY FOR BREACH OF THIS WARRANTY IS EXPRESSLY LIMITED TO REPAIR OR REPLACEMENT OF DEFECTIVE ITEMS. Any product which, under normal use and service, is proven to breach the warranty contained herein within ONE YEAR from date of sale will, upon examination by Chaney, and at its sole option, be repaired or replaced by Chaney. In all cases, transportation costs and charges for returned goods shall be paid for by the purchaser. Chaney hereby disclaims all responsibility for such transportation costs and charges. This warranty will not be breached, and Chaney will give no credit for products it manufactures which shall have received normal wear and tear, been damaged, tampered, abused, improperly installed, damaged in shipping, or repaired or altered by others than authorized representatives of Chaney.

THE ABOVE-DESCRIBED WARRANTY IS EXPRESSLY IN LIEU OF ALL OTHER WARRANTIES, EXPRESS OR IMPLIED, AND ALL OTHER WARRANTIES ARE HEREBY EXPRESSLY DISCLAIMED, INCLUDING WITHOUT LIMITATION THE IMPLIED WARRANTY OF MERCHANTABILITY AND THE IMPLIED WARRANTY OF FITNESS FOR A PARTICULAR PURPOSE. CHANEY EXPRESSLY DISCLAIMS ALL LIABILITY FOR SPECIAL, CONSEQUENTIAL OR INCIDENTAL DAMAGES, WHETHER ARISING IN TORT OR BY CONTRACT FROM ANY BREACH OF THIS WARRANTY. SOME STATES DO NOT ALLOW THE EXCLUSION OR LIMITATION OF INCIDENTAL OR CONSEQUENTIAL DAMAGES, SO THE ABOVE LIMITATION OR EXCLUSION MAY NOT APPLY TO YOU. CHANEY FURTHER DISCLAIMS ALL LIABILITY FROM PERSONAL INJURY RELATING TO ITS PRODUCTS TO THE EXTENT PERMITTED BY LAW. BY ACCEPTANCE OF ANY OF CHANEY'S EQUIPMENT OR PRODUCTS, THE PURCHASER ASSUMES ALL LIABILITY FOR THE CONSEQUENCES ARISING FROM THEIR USE OR MISUSE. NO PERSON, FIRM OR CORPORATION IS AUTHORIZED TO ASSUME FOR CHANEY ANY OTHER LIABILITY IN CONNECTION WITH THE SALE OF ITS PRODUCTS. FURTHERMORE, NO PERSON, FIRM OR CORPORATION IS AUTHORIZED TO MODIFY OR WAIVE THE TERMS OF THIS PARAGRAPH, AND THE PRECEDING PARAGRAPH, UNLESS DONE IN WRITING AND SIGNED BY A DULY AUTHORIZED AGENT OF CHANEY. THIS WARRANTY GIVES YOU SPECIFIC LEGAL RIGHTS, AND YOU MAY ALSO HAVE OTHER RIGHTS WHICH VARY FROM STATE TO STATE.

For in-warranty repair, please contact:

Customer Care Department
Chaney Instrument Company
965 Wells Street
Lake Geneva, WI 53147

Chaney Customer Care
877-221-1252
Mon-Fri 8:00 a.m. to 4:30 p.m. CST

www.chaneyinstrument.com



This device complies with part 15 of the FCC rules. Operation is subject to the following two conditions:

- 1- This device may NOT cause harmful interference, and
- 2- This device must accept any interference received, including interference that may cause undesired operation.

NOTE: This equipment has been tested and found to comply with the limits for a Class B digital device, pursuant to Part 15 of the FCC rules. These limits are

designed to provide reasonable protection against harmful interference in a residential installation. This equipment generates, uses and can radiate radio frequency energy and, if not installed and used in accordance with the instructions, may cause harmful interference to radio communications. However, There is no guarantee that interference will not occur in a particular installation. If this equipment does cause harmful interference to radio or television reception, which can be determined by turning the equipment off and on, the user is encouraged to try to correct the interference by one or more of the following measures:

- Reorient or relocate the receiving antenna.
- Increase the separation between the equipment and the receiver.
- Connect the equipment into an outlet on a circuit different from that to which the receiver is connected.
- Consult the dealer or an experienced radio/TV technician for help.

NOTE: The manufacturer is not responsible for any radio or TV interference caused by unauthorized modifications to this equipment. Such modifications could void the user authority to operate the equipment.

Patent numbers: 5,978,738; 6,076,044; 6,597,990
ACURITE® is a registered trademark of the Chaney Instrument Co.
Lake Geneva, WI

00526W INST 120210

ACURITE®
DESIGNED TO WORK FOR YOU™



Thermometer
model #00526W

Instruction Manual

Introduction

The Acurite® Thermometer with wireless outdoor sensor collects outside weather data and sends the data via wireless signal to the Display Unit. This thermometer has been designed to be easy to install and use.

The display unit houses a liquid crystal display (LCD) which will calculate and display the temperature data received from the wireless sensor outside. The display unit features a sensor that measures the indoor temperature. The display also features a character that will display appropriate clothing suggestions, based on the current outdoor temperature reading. The Display Unit is powered with two "AA" alkaline batteries (not included).

The wireless outdoor sensor is completely wireless and contains a sensor for measuring outdoor temperature. The wireless outdoor sensor is powered with two "AA" alkaline or lithium batteries (not included).

Please read through this manual to learn more. Keep this manual for future reference.

Parts List model #00526W

1. Display Unit
2. Wireless outdoor sensor

Display Features

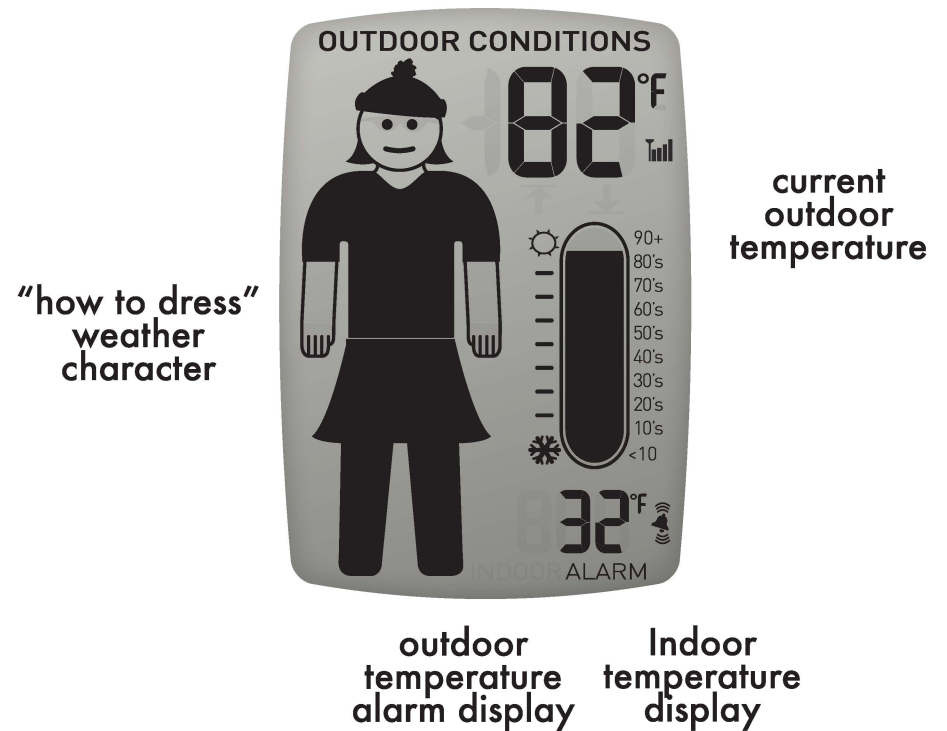

PRODUCT REGISTRATION

To receive product updates
and information,

Log on to

www.chaneyinstrument.com

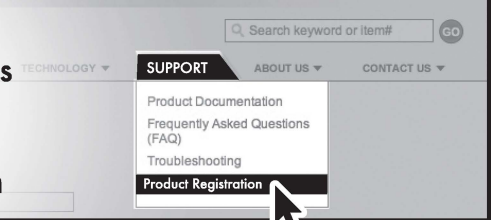

Battery Choice & Temperature Range

Extended periods of cold temperatures (below -4°F / -20°C) can cause alkaline batteries to function improperly. This will cause the outdoor wireless sensor to stop transmitting temperature readings. Use lithium batteries in these low temperature conditions to ensure continued operation for wireless sensors placed outdoors.

LITHIUM BATTERIES	-40°F (-40°C)	(70°C) 158°F
ALKALINE BATTERIES	-4°F (-20°C)	(70°C) 158°F



PLEASE DISPOSE OF OLD OR DEFECTIVE BATTERIES IN AN ENVIRONMENTALLY SAFE WAY AND IN ACCORDANCE WITH YOUR LOCAL LAWS AND REGULATIONS.

BATTERY SAFETY: Clean the battery contacts and also those of the device prior to battery installation. Remove batteries from equipment which is not to be used for an extended period of time. Follow the polarity (+/-) diagram in the battery compartment. Promptly remove dead batteries from the device. Dispose of used batteries properly. Only batteries of the same or equivalent type as recommended are to be used. DO NOT incinerate used batteries. DO NOT dispose of batteries in fire, as batteries may explode or leak. DO NOT mix old and new batteries or types of batteries (alkaline/standard). DO NOT use rechargeable batteries. DO NOT recharge non-rechargeable batteries. DO NOT short-circuit the supply terminals.

Installing Batteries - Wireless Sensor

Remove the battery compartment cover. Install 2 fresh "AA" batteries as shown here. **BATTERIES MUST BE INSTALLED FOR THE SENSOR TO OPERATE**



Installing Batteries - Display Unit

Remove the battery compartment cover. Install 2 fresh "AA" batteries as shown here.

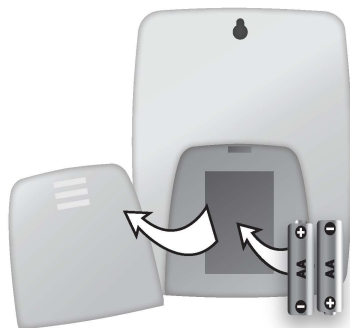

Display Unit : Set Preferences

This wireless thermometer allows you to choose °F or °C temperature display. You may also choose to display a boy OR girl "how to dress" weather character.

Press and hold the "SET" button to enter into set mode. The temperature unit (°F or °C) will begin blinking.

To adjust the currently selected (flashing) preference item, press the "↓" or "↑" buttons.

To save your adjustments, press the "SET" button again to move on to adjusting the next preference. The preference set order is as follows:

TEMPERATURE SCALE (°F or °C)
BOY OR GIRL WEATHER CHARACTER

You will automatically exit SET MODE if no entries are changed for 30 seconds.

Display Unit : MIN/MAX Memory

This wireless forecaster features a MIN/MAX memory feature which records the MINIMUM and MAXIMUM outdoor temperature and indoor temperature/ humidity readings.

To view the MINIMUM outdoor temperature and indoor temperature/humidity reading, press and release the "▼" button. Note the "MIN" icon on the display. To clear the MIN recorded values, press and hold the "▼" button while in the MIN view mode. Dashes will display in the display to confirm you have cleared the MIN values for outdoor temperature and indoor temperature/humidity.

To view the MAXIMUM recorded outdoor temperature and indoor temperature/ humidity reading, press and release the "▲" button. Note the "MAX" icon on the display. To clear the MAX recorded values, press and hold the "▲" button while in the MAX view mode. Dashes will display to confirm you have cleared the MAX values for outdoor temperature and indoor temperature/humidity.

Now that setup is complete, you must choose a location to place the wireless sensor and the display unit. The wireless sensor **MUST** be placed less than 165 feet (50 m) away from the display unit.

This wireless forecaster uses radio frequency for communication, which is susceptible to interference from other electronic devices and large metallic items or thick walls. Always place both units at least 3 feet (.91 m) away from appliances (TV, microwave, radios, etc.) or objects that may interfere with the wireless communication (large metal surfaces, thick stone walls, etc.).

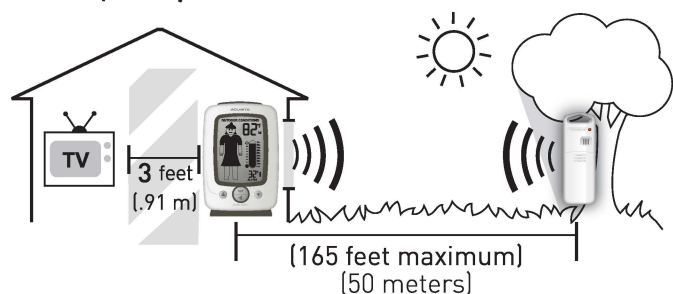

Placement of Display Unit

Place the display unit in a dry area free of dirt and dust. To help ensure an accurate indoor temperature measurement, be sure to place the display unit out of direct sunlight, and away from any heat sources or vents in your home. There are 2 placement options for the display unit. You may hang the main unit on a wall using the integrated hang hole. Alternatively, you may place the main unit on a table top or other flat surface using the table top display stand.

Placement of Sensor

The wireless sensor **MUST BE PLACED OUTDOORS** to observe outdoor temperatures. The wireless sensor must be placed less than 165 feet (50 m) from the display unit. The wireless sensor is water resistant and is designed for general outdoor use. However, to extend the life of the product, place the wireless sensor in an area protected from direct weather elements. To ensure an accurate outdoor temperature measurement, be sure the wireless sensor is placed out of direct sunlight and away from any heat sources.

There are 2 placement options for the wireless sensor. You may hang it using one of the two integrated hang holes, or use string (not included) to hang it from a suitable location like a well covered tree branch.

"How to Dress" Character

TEMPERATURE: "how to dress" character

This thermometer features an icon which will automatically show different clothing recommendation to help you prepare for your day. This recommendation is based on current temperature. Below are a few examples of clothing recommendations.

	GIRL					
°F	<0	20	40	60	80	90+
	BOY					

INDOOR TEMPERATURE

Indoor temperature display utilizes the same display area as the alarm value display, indoor temperature will only display when the alarm is OFF.

OUTDOOR TEMPERATURE: alarm

This thermometer features an optional temperature alarm. To turn on the temperature alarm, press the "🔔" button located below the display. The default preset alarm value of 32°F will be displayed, and the alarm will now sound if the outdoor temperature reaches 32°F. To change the temperature at which the alarm will sound, press and HOLD the "🔔" button. The alarm value will flash, press the "⬇️" or "⬆️" buttons to adjust the alarm value.

When an alarm sounds, press the "ALARM STOP" to silence it- this button located on top of the display. Please note that the alarm will sound again once the alarm temperature is reached again. The only way to be certain that the alarm will not sound is to turn the alarm off by pressing the "🔔" button.

TEMPERATURE ALARM NOTE:

When you set an alarm value below 50°F, the alarm will only sound if the temperature has **FALLEN** below that set alarm value. When you set an alarm value above 50°F, the alarm will only sound if the temperature has **RISEN** above that set alarm value.

Problem	Possible Solution
Bad Wireless Sensor Reception  no bars	Relocate the main unit and/or the wireless sensor. Both units must be within 165 feet (50m) from each other. Make sure both units are placed at least 3 feet (.91 m) from other electronic appliances and devices that may interfere with the wireless communication (such as TV's, microwaves, computers etc). NOTE: It may take up to 20 minutes for the main unit to re-synchronize with the sensor when batteries are replaced. Use lithium batteries in sensor when temperature is below -4°F (-20°C).
Display Unit Screen Not Working	Batteries may need replacing Check that batteries are correctly installed



Please DO NOT return product to the retail store.
For technical assistance and product return information, please call
Customer Care: **877-221-1252** Mon. - Fri. 8:00 A.M. to 4:30 P.M. (CST)

www.chaneyinstrument.com

PRODUCT REGISTRATION

To receive product updates
and information,

Log on to

www.chaneyinstrument.com

SUPPORT

Product Documentation
Frequently Asked Questions (FAQ)
Troubleshooting
Product Registration

Product Facts

Batteries: 4 x "AA" (not included)

Lithium Batteries Recommended in
Outdoor Sensor if temperatures are
below -4°F

Measurement Ranges

Outdoor Temperature: **-40°F to 158°F**
-40°C to 70°C

Indoor Temperature: **32°F to 122°F**
0°C to 50°C

Wireless Range: 165 ft / 50 m MAX

Depending on home construction materials

MADE IN CHINA
HECHO EN CHINA
Limited One
Year Warranty
Instructions &
Warranty Enclosed

Customer Care:
877-221-1252

www.chaneyinstrument.com

Patent numbers: 5,978,738; 6,076,044; 6,597,990
ACURITE® is a registered trademark of the Chaney Instrument Co.
Lake Geneva, WI