

### Digital Pocket Scale model 00954



#### CONTENTS

Package Contents .....	2	Using the Scale .....	5
Customer Support .....	2	Troubleshooting .....	7
Features & Benefits.....	3	Care & Maintenance.....	7
Setup .....	4	Specifications.....	7
Install or Replace Battery.....	4		

**Questions?** Contact Customer Support at  
(877) 221-1252 or visit [www.AcuRite.com](http://www.AcuRite.com).

**SAVE THIS MANUAL FOR FUTURE REFERENCE.**



Congratulations on your new AcuRite product. To ensure the best possible product performance, please read this manual in its entirety and retain it for future reference.

## Package Contents

1. Scale
2. Cover
3. Instruction Manual

## Customer Support

AcuRite customer support is committed to providing you with best-in-class service. **For assistance**, please have the model number of this product available and contact us in any of the following ways:



(877) 221-1252



info@chaney-inst.com

24/7 support at [www.AcuRite.com](http://www.AcuRite.com)

- ▶ Installation Videos
- ▶ Register your Product
- ▶ Instruction Manuals
- ▶ Support User Forum
- ▶ Replacement Parts
- ▶ Submit Feedback & Ideas

# Features & Benefits

## TOP

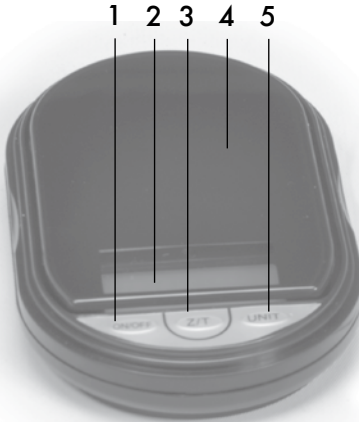

## TOP

1. **ON/OFF Button**
2. **Display**
3. **ZERO/TARE Button**
4. **Weighing Area**
5. **UNIT Button**  
Toggle measurement units between grams (g), ounces (oz), pennyweight (dwt), troy ounces (oz t), and piece count.

## BACK

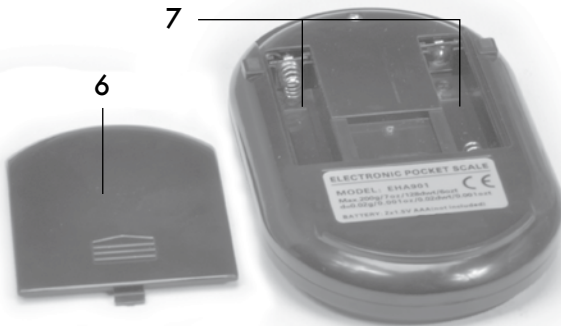

## BACK

6. **Battery Compartment Cover**
7. **Battery Compartment**

## DISPLAY

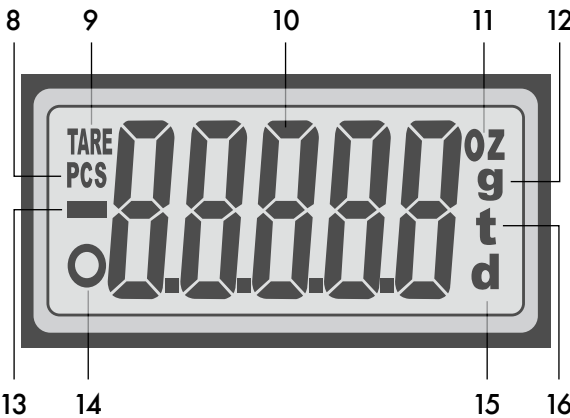

## DISPLAY

8. **Piece Count Indicator**
9. **Tare Indicator**
10. **Current Weight**
11. **Weight Units Ounces (OZ)**
12. **Weight Units Grams (g)**
13. **Minus Indicator**  
Weight of item(s) removed from scale.
14. **Zero Indicator**
15. **Weight Units Pennyweight (d)**  
(1dwt=1.56g=0.054oz)
16. **Weight Units Troy Ounce (t)**  
(1oz t=31.1g=1.097oz)

## Install or Replace Battery

1. Remove the battery compartment cover.
2. Insert 2 AAA alkaline batteries into the battery compartment, as shown. Follow the polarity (+/-) diagram in the battery compartment.
3. Replace the battery cover.

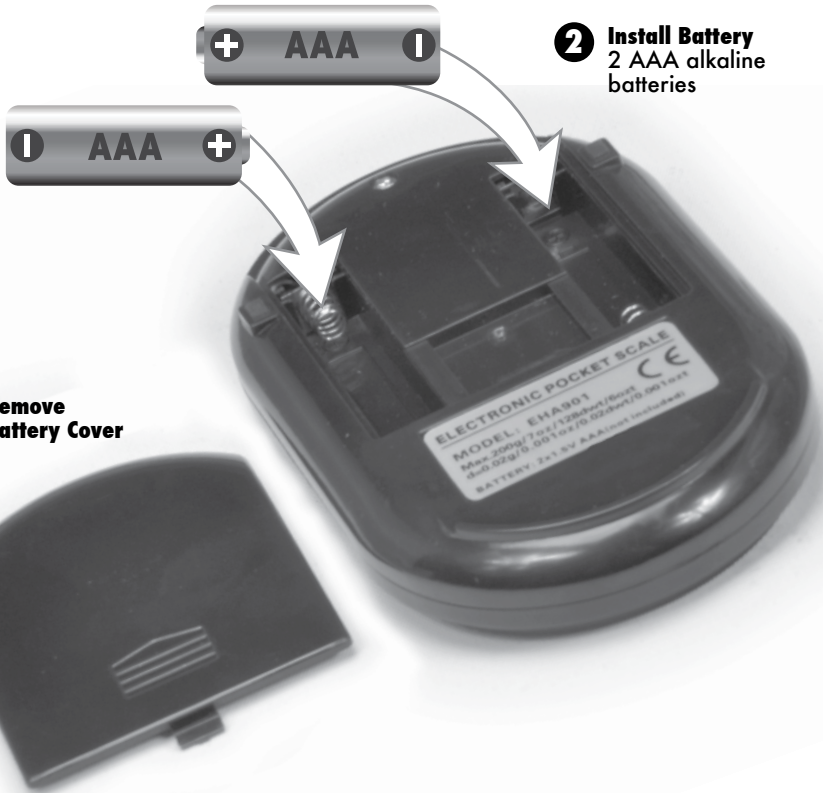

**1** Remove Battery Cover

**2** Install Battery  
2 AAA alkaline  
batteries



**PLEASE DISPOSE OF OLD OR DEFECTIVE BATTERIES IN AN ENVIRONMENTALLY SAFE WAY AND IN ACCORDANCE WITH YOUR LOCAL LAWS AND REGULATIONS.**

**BATTERY SAFETY:** Clean the battery contacts and also those of the device prior to battery installation. Remove batteries from equipment which is not to be used for an extended period of time. Follow the polarity (+/-) diagram in the battery compartment. Promptly remove dead batteries from the device. Dispose of used batteries properly. Only batteries of the same or equivalent type as recommended are to be used. DO NOT incinerate used batteries. DO NOT dispose of batteries in fire, as batteries may explode or leak. DO NOT mix old and new batteries or types of batteries (alkaline/standard). DO NOT use rechargeable batteries. DO NOT recharge non-rechargeable batteries. DO NOT short-circuit the supply terminals.

## Using the Scale

Remove the cover from the top of the scale by lifting it from one side. Cover may be used to weigh items on the scale (optional).

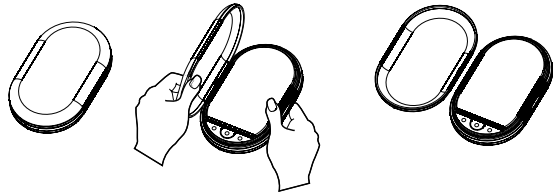

## Measure Weight

1. Place the scale on a flat, stable surface.
2. Press the "ON/OFF" button to power the scale ON.
3. Wait for the display to show "0.00".
4. Press the "UNIT" button to select your preferred measurement units. Measurement units include: GRAMS, OUNCES, PENNYWEIGHT, TROY OUNCES, and PIECE COUNT.
5. Place item(s) to be weighed on the center of the scale.
6. Weight will be shown on the display. Press the "UNIT" Button to convert the measurement units between grams (g), ounces (OZ), dwt (d), oz t (t) and piece counting mode (See below).

## Piece Counting Mode

When Piece Counting Mode is selected, "PCS" will show on the display. To use Piece Counting Mode you must first calibrate the scale to an item. Next, you can place any amount of that same item on the scale and the scale will display the quantity (pieces) of that item.

### Calibrate the Scale to an Item

1. Place the scale on a flat, stable surface.
2. Press the "ON/OFF" button to power the scale ON.
3. Press the "UNIT" button to select Piece Counting Mode ("PCS" is shown on the display).
4. Press and HOLD the "UNIT" button for 3 seconds to select 25, 50 or 100 pieces. When a quantity has been chosen, place that same number of items on the weighing platform.
5. The quantity selected will flash on the display. The display stops flashing when the scale has determined the weight of the items.
6. Weight will be shown on the display.

### Determine the Quantity (Pieces) of an Item

1. Press the "ON/OFF" button to power the scale ON (if applicable).
2. Place any quantity of the item the scale has been calibrated to in the steps above on the scale.

Continued on page 6.

3. Weight will be shown on the display.
4. Press the "UNIT" button until "PCS" is indicated on the display.
5. Quantity of items placed on the scale will be shown on the display.

Please Note: To determine the quantity of a different item than the item the scale has been calibrated to, repeat the steps in "Calibrate the Scale to an Item" (page 5).

## **Zero & Tare Functions**

To measure items as they are added, use the Zero and Tare Functions. If the weight of the items being measured is below 4% of the scale's capacity (less than 8 g/0.282192 oz), the Zero function is used. If the weight of the items exceeds 4% of the scale's capacity, the Tare function is used.

1. Place item(s) on the center of the scale.
2. Weight will be shown on the display.
3. Without removing the item(s), press "Z/T" button to reset display to "0:00".
4. Depending on the weight of the item(s), you will see the Zero indicator "○" or the Tare indicator "TARE" on the display.
5. With the first item(s) still in place, add the next item to the scale. The display will now show the weight of that item.
6. Press "Z/T" button to view the combined weight of the two items.
7. Press "Z/T" button again to reset the display to "0:00".
8. Repeat these steps (5-7) until all items have been added.

## **Minus Function**

If you add multiple items to the scale at one time to get a total weight, you can measure the weight of a single item or ingredient by using the Minus Function:

1. Add item(s) to the scale.
2. Total weight will be shown on the display.
3. Press "Z/T" button to reset the display to "0:00".
4. Remove an item.
5. Value shown on the display with the Minus Function indicator (-) indicates the weight of the removed item.
6. Press "Z/T" button to view the total weight of any remaining items on the scale.
7. Repeat these steps (4-6) as needed.

## **Momentary Backlight**

The display's momentary backlight will turn on when the scale is powered on. Backlight turns off after 30 seconds of inactivity. Backlight turns on again while scale is in use.

## Warning Messages



Replace battery (see page 4).



Maximum capacity has been exceeded. Remove items to prevent damage.

## Power the Unit ON/OFF

The scale will automatically power off when the display shows "0:00" or the same weight for 2 minutes. Press "ON/OFF" to manually power the scale ON or OFF.

## Storage

The scale should be stored in a cool dry place.

## Troubleshooting

Problem	Possible Solution
Display screen not working	<ul style="list-style-type: none"><li>Check that the batteries are installed correctly. Batteries may need to be replaced.</li></ul>

**If your AcuRite product does not operate properly after trying the troubleshooting steps, visit [www.AcuRite.com](http://www.AcuRite.com) or call (877) 221-1252 for assistance.**

## Care & Maintenance

Store in a dry location at room temperature. Clean with a soft, damp cloth. DO NOT immerse in water or use caustic cleaners or abrasives. All parts should be wiped clean immediately after direct contact with foods. Use the scale on a hard, flat surface. DO NOT strike, shake or drop the scale. Scale is not designed for commercial use.

## Specifications

<b>MAX WEIGHT CAPACITY</b>	200 g / 7 oz / 128 dwt / 6 ozt
<b>POWER</b>	2 x AAA alkaline batteries

# ACURITE®



Weather  
Stations



Temperature  
& Humidity



Weather  
Alert Radio



Kitchen  
Thermometers  
& Timers



Clocks

*It's more than accurate, it's ACURITE®.*

AcuRite offers an extensive assortment of precision instruments, designed to provide you with information you can depend on to Plan your day with confidence™.

[www.AcuRite.com](http://www.AcuRite.com)

©Chaney Instrument Co. All rights reserved. AcuRite is a registered trademark of the Chaney Instrument Co., Lake Geneva, WI 53147. All other trademarks and copyrights are the property of their respective owners. AcuRite uses patented technology. Visit [www.AcuRite.com/patents](http://www.AcuRite.com/patents) for details.